



## Board Inverter Module

*BI2000*

**POLY DISPENSING SYSTEMS**  
S Y S T E M E S   D E   D O S A G E   I N D U S T R I E L

## System Specifications

### Maximum Pallet Weight

10 lbs  
4.5 kg

### Conveyor Speed

0.15 m/min to 24 m/min  
0.5 ft/min to 80 ft/min

### Working Width

50 to 500 mm  
Maximum Pallet Length  
550mm

### Component Clearance

100 mm (4 in) top and bottom  
4.75 mm (0.187 in) in edge carrying (SME-  
MA)

### Conveyor Height

890 to 965 mm

### Power Requirements

100V - 240V, 50/60Hz

### Certification

CE

## BI2000

### Board Inverter Module



The BI2000 is a compact inverting module for use with printed circuit boards and pallets within an inline process. While configured in a PVA production line, the BI2000 exposes the underside of an assembly for processing. Once inverted, the assembly can continue on to the next module, or return to the original workstation in a bi-directional mode.

The BI2000 has many integrated features including:

- Edge chain conveyor with adjustable tension guides
- Bi-directional conveyor travel
- Pneumatic inverting mechanism
- SMEMA communications interface
- Four-inch top and bottom side component clearance
- Unitronics PLC/HMI
- OIT touch screen interface
- Standard hand crank conveyor adjust and optional automatic conveyor adjust
- Optional inlet and exit shutters

For more information, please contact POLY DISPENSING SYSTEMS at [contact@polydispensing.com](mailto:contact@polydispensing.com) or contact your local representative.



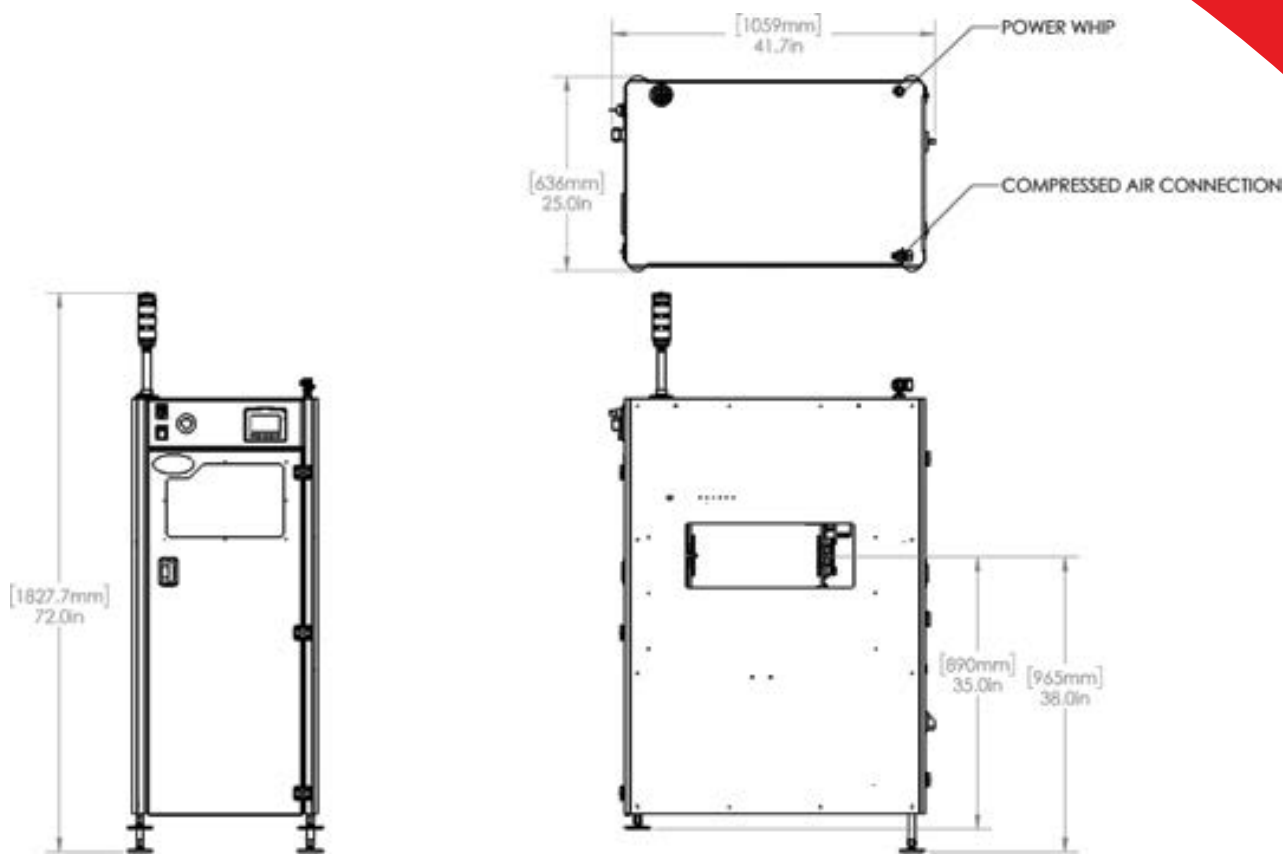

# POLY DISPENSING SYSTEMS

SYSTEMES DE DOSAGE INDUSTRIEL

122 chemin de la Cavée - 78630 Orgeval • [contact@polydispensing.com](mailto:contact@polydispensing.com) • Tel : + 33 (0)1 39 62 40 92  
[www.polydispensing.com](http://www.polydispensing.com)